

Name: _____

Klasse: _____









Datum: _____

Herstellung der 45° Schiene in CAD – „Volumenkörper“

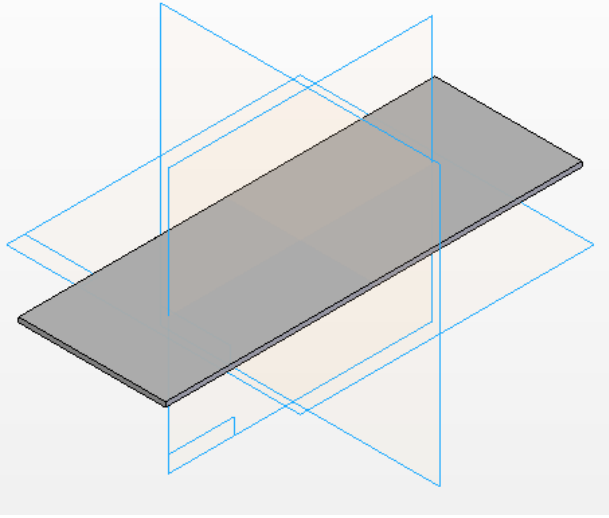
Aufgabenstellung: Erzeuge die 45° Schiene in Isometrie.

Die Aluplatte hat die Maße 60 x 2 x 170. Verwende dazu die abgebildeten Befehle und schreibe den Namen des Befehls darunter.

Planungsschritte in SE-V20

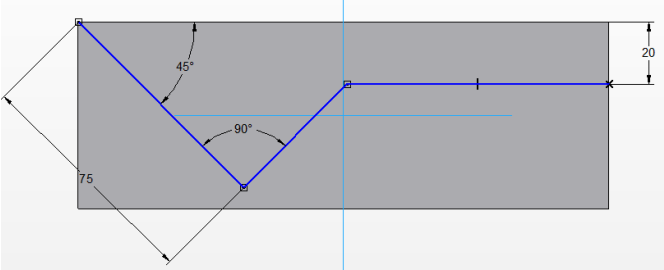
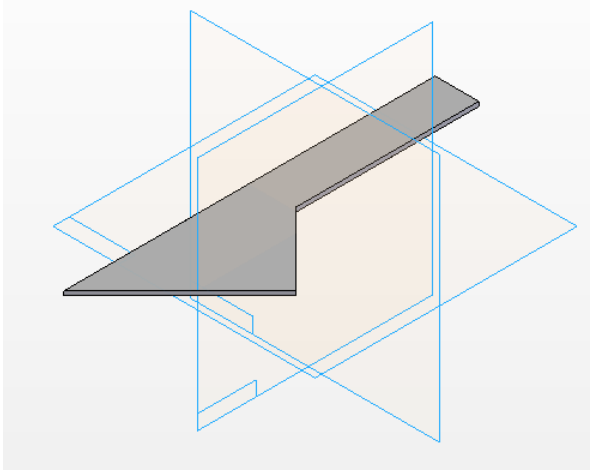
Arbeitsschritte	Befehle	Grafische Darstellung
<p>1. Grundform erzeugen</p>	 <hr/>  <hr/>  <hr/>	
<p>2. Aussparungen heraus-schneiden</p>	 <hr/>  <hr/>  <hr/>  <hr/>  <hr/>	 <div style="display: flex; justify-content: center; gap: 20px; margin: 10px 0;"> Zurück Fertig stellen </div> 

Name: _____

Klasse: _____

Datum: _____

3. Senkbohrung

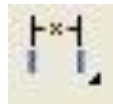
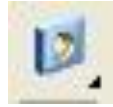

Zurück

Fertig stellen

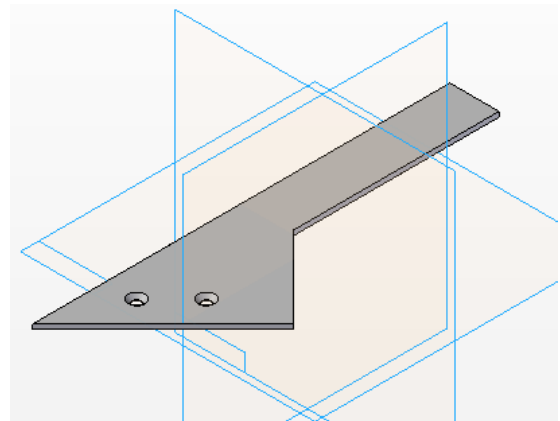
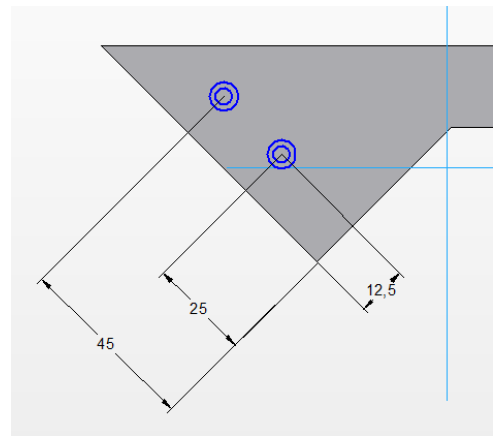
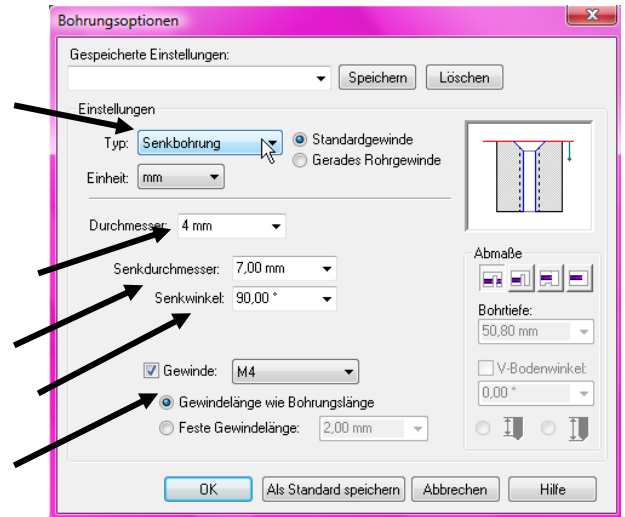

Notizen:
